

# 6 EASY STEPS

## Flat Section

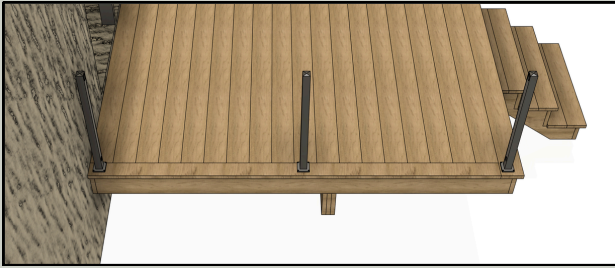

### 1 Install End Posts



- Position first end post near deck edge where lag bolts secure to adequate blocking/support
- Square post with deck edge and mark holes
- Position second end post where required with the holes facing the first end post

### 3 Measure and Install Rails



- Measure the distance from post to post and cut top and bottom rails that fit in. Insert rails into slots in end posts

### 5 Install Pickets with Spacers



- Snap spacers onto bottom rail, starting with flat end on one side and working across
- Center spacers for equal spacing on each side (spacers are pre-cut to meet building code)
- Use a utility knife to mark the spacer where to cut

### 2 Install Additional Posts (If Applicable)

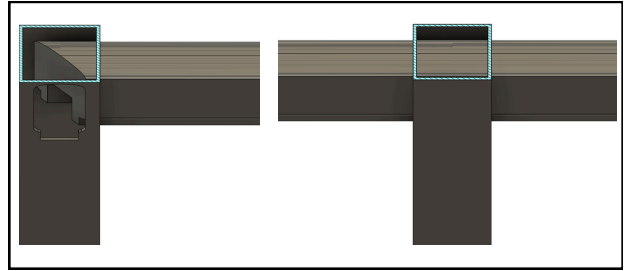

- Corner posts: Cut rails at 45-degree angle to fit into corner post
- Line posts: Slide rails through line post. A splice is placed inside the rails to connect longer sections

### 4 Level and Secure

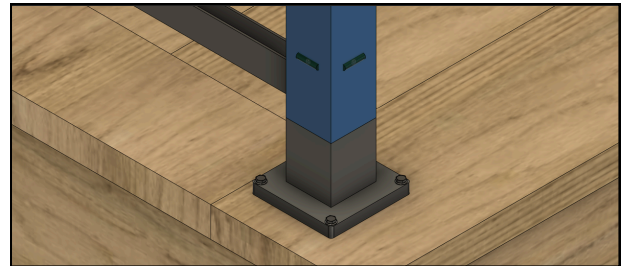

- Level each post
- Secure bottom rail using two 1.5-inch screws (one per side) on inside of bottom rail or outside of post to prevent moving
- Do not add the screws on the top rail just yet (we will do that later on)

### 6 Secure Top Rail

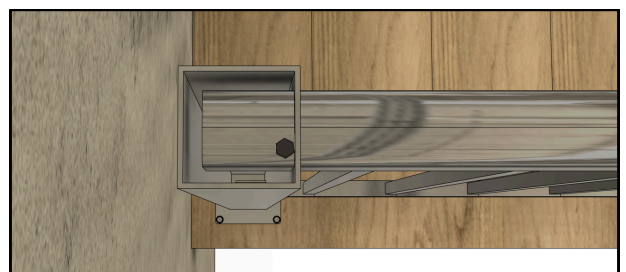

- Gently remove post caps from end posts. You'll need to compress the rail together so that there's no gaps from the post to the spacer and secure it with a screw



### 1 Install Posts

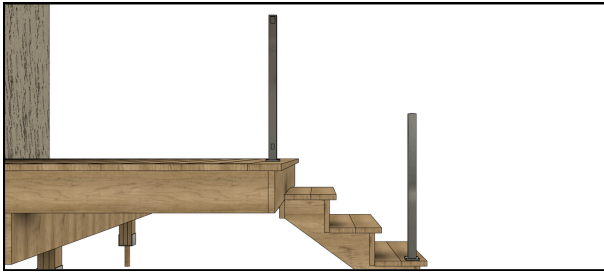

- Usually the post at the top will be an end post if it needs to continue around the deck
- Use a stair post (no hole) at the bottom of the steps
- Use provided screws to secure posts
- (Important) Level post vertically and use shims if needed

### 2 Measure and Install Rails

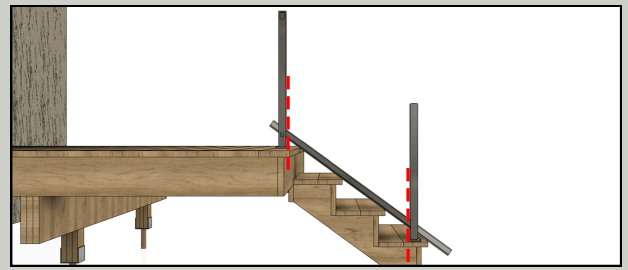

- Measure distance between posts and cut rails longer to extend past each post
- Lay rail on stair tread against post: do not let rail move around, and mark the angles you'll need to cut by using a pencil
- Cut  $\frac{1}{8}$ " longer on each side for a snug fit

### 3 Installing pickets on the post to use as brackets

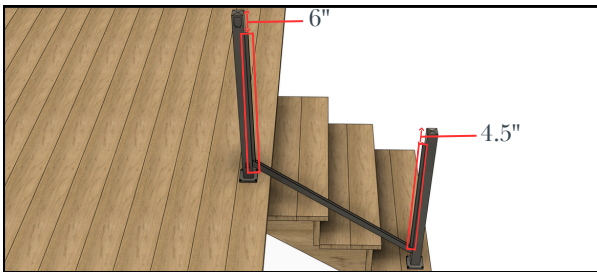

- Cut 2 pickets about 2" shorter using the same saw angle as you did to cut the top and bottom rails
- Attach the first picket 6" down on the top stair post
- Attach the second picket 4.5" down on the bottom stair post
- Secure the bottom rail to the pickets, and then secure the top rail to the pickets

### 4 Prepare Pickets and Spacers

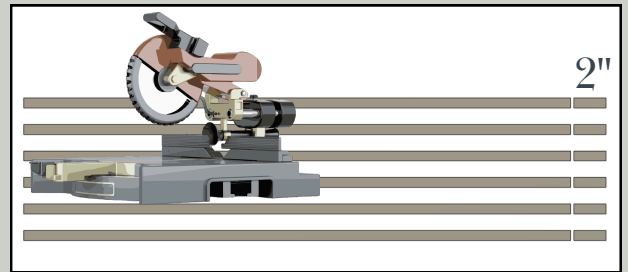

- Cut the number of pickets you'll need to fill the stair railing to match the first two attached pickets
- Snap spacers onto the bottom rail and spread evenly to check spacing

### 5 Trim Spacers

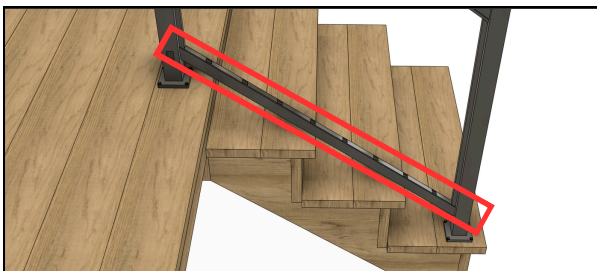

- Match the spacing on the ends
- Move the spacers around until you have even space on each side of the run
- Trim spacer to that length, and that will be the starting spacer

### 6 Install Pickets



- Install the pickets, add the spacers for the top rail
- Trim the last spacer to cover the final spacing